

MODEL: LR14/AM-2

Type: Alkaline-Manganese Dioxide Primary Battery

SPECIFICATIONS

Nominal Voltage : 1.5 V

• DIMENSIONS

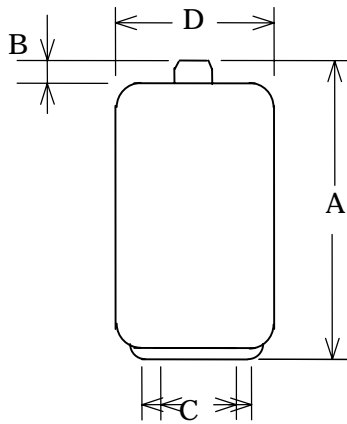

Mark	Items	Standards (mm)
A	Overall Height	49.3 ± 0.7
B	Height of Positive Terminal	1.5 Min.
C	Diameter of Negative Terminal	13.0 Min.
D	External Diameter	25.55 ± 0.65

• CHARACTERISTICS (Fresh)

Items	Standards	Conditions
O.C.V.	Min. 1.50 V	
Duration	Min. 12 h	Load Resistance: 3.9 * 1h/day Cut off Voltage: 0.8 V
	Min. 23 h	Load Resistance: 6.8 * 1h/day Cut off Voltage: 0.9 V
	Min. 77 h	Load Resistance: 20 * 4h/day Cut off Voltage: 0.9 V

• Country of origin : Japan