

# SONY

## MODEL: LR20/AM-1

Type: Alkaline-Manganese Dioxide Primary Battery

### SPECIFICATIONS

Nominal Voltage : 1.5 V

#### • DIMENSIONS

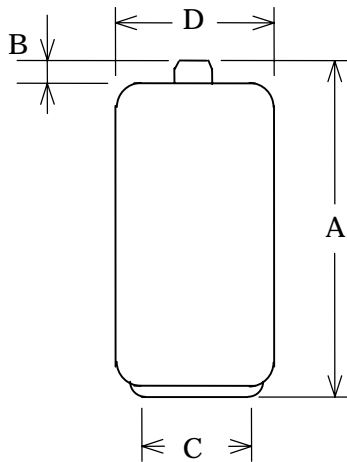

Mark	Items	Standards (mm)
A	Overall Height	60.5 ± 1.0
B	Height of Positive Terminal	1.5 Min.
C	Diameter of Negative Terminal	18.0 Min.
D	External Diameter	33.25 ± 0.95

#### • CHARACTERISTICS (Fresh)

Items	Standards	Conditions
O.C.V.	Min. 1.50 V	
Duration	Min. 15 h	Load Resistance: 2.2 * 1h/day Cut off Voltage: 0.8 V
	Min. 25 h	Load Resistance: 3.9 * 1h/day Cut off Voltage: 0.9 V
	Min. 81 h	Load Resistance: 10 * 4h/day Cut off Voltage: 0.9 V

• Country of origin : Japan